

440G-S Spartan Guard Locking Switches

The 440G-S Spartan guard locking switches have the following features:

- Type 2 interlock with guard locking and low coding
- Power to release
- Lid mounted status indication
- Rotatable head: 4 possible key entry slots
- A catch kit with actuator alignment protects the unit from actuator damage due to poor guard alignment
- Manual release points with security screws or special key allow the switch to be unlocked in the event of an unforeseen and uncommon circumstance, such as a power failure



Specifications

Attribute	Value
Safety ratings	
Standards	ISO 14119, IEC 60947-5-1
Safety Classification	Type 2 interlocking device with guard locking and low coding per ISO 14119
Functional Safety	https://literature.rockwellautomation.com/idc/groups/literature/documents/sr/safety-sr001_-en-e.pdf
Certifications	cULus Listed, TÜV Certified, and CE Marked for all applicable directives www.rockwellautomation.com/certification/overview.page
Outputs	
Safety Contacts	2 N.C. or 3 N.C. direct opening action
Auxiliary Contacts	1 N.O.
Thermal Current (Ith)	10A
Insulation Voltage	500V
Impulse withstand Voltage	2500V
Utilization Category	AC 15
AC (Ue)	500V 250V 100V
(Ie)	1A 2A 5A
DC	250V/0.5A 24V/2A
Maximum Switched Current/Volt/Load	500V/500VA
Min Current	5V 5mA DC
Safety Contact Gap	>2mm
Solenoid Characteristics	
Holding force F_{max}	1000 N (225 lb)
Holding force F_{zh}	770 N (173 lb)
Power Supply	24V AC/DC, 110V AC, 230V AC (solenoid)
Solenoid Power	Typically 7W 100% ED
Operating Characteristics	
Max Actuation Speed	160 mm per second (6.3 in. per sec)
Max Actuation Frequency	1 cycle per second
Mechanical Life	1,000,000 operations

Environmental	
Pollution Degree ⁽¹⁾	3
Operating Temperature	-20°C...+60°C (-4°F ... +140°F)
Protection	IP 67
Attribute	Value
Physical Characteristics	
Case Material	UL Approved glass filled polyester
Actuator Material	Stainless steel
Conduit Entry	1 x M20 or quick disconnect style
Fixing	2 x M5
Mounting	Any position
Electrical Life	1,000,000 operations
Weight	260 g (0.57 lb)
Color	Red
Min Operating Radius	175 mm (6.9 in.)
LED Indication	Solenoid monitor LED



(1) Conductive pollution occurs, or dry, non conductive pollution occurs which becomes conductive due to condensation.

Product Selection

Actuator	Solenoid Voltage	Contacts		Cat. No.		
		Safety	Aux.	M20 Conduit	M20 Conduit/ 1/2in Adaptor	Quick Disconnect
Standard	24 V AC/DC	2 N.C.	1 N.O.	440G-S36001	440G-S36044	440G-S36058
		3 N.C.	–	440G-S36007	440G-S36047	40G-S36059
	110 V AC/DC	2 N.C.	1 N.O.	440G-S36003	440G-S36045	440G-S36060
		3 N.C.	–	440G-S36009	440G-S36048	440G-S36061
	230V AC/DC	2 N.C.	1 N.O.	440G-S36005	440G-S36046	440G-S36062
		3 N.C.	–	440G-S36011	–	440G-S36063
	Mating cable					889M-F12X9AE-x ⁽¹⁾

(1) Replace x with 2 (2 m), 5 (5 m), or 10 (10 m) for standard cable lengths.

Accessories

Description	Catalog Number
 Replacement Actuator with Catch Retainer and Guide	440G-A36050
 Manual Release Key	440G-A36026

Approximate Dimensions

Dimensions are shown in mm (in.). Dimensions are not intended to be used for installation purposes.

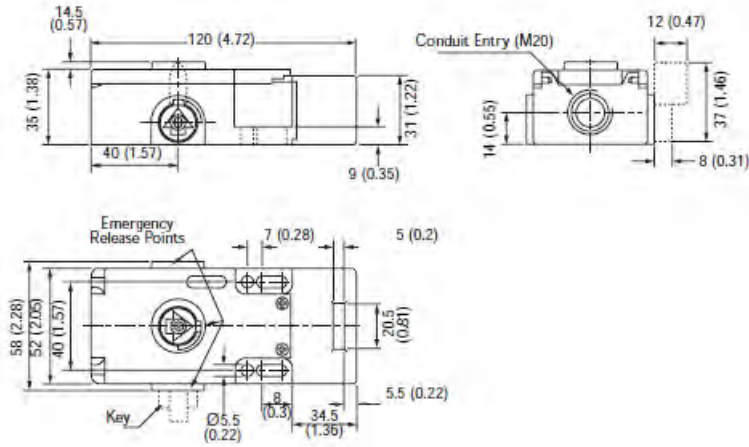

Typical Wiring Diagrams

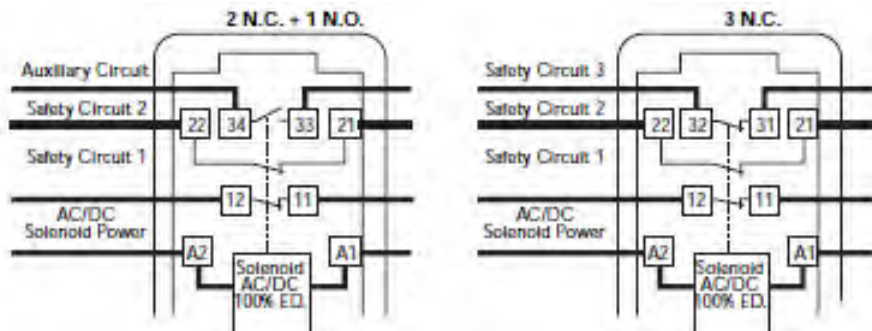

Connector Pinout		2 N.C. + 1 N.O.		3 N.C.	
		Terminal	Contact	Terminal	Contact
	1	A1	Solenoid	A1	Solenoid
	3	A2	Power	A2	Power
	4	11	N.C.	11	N.C.
	6	12	N.C.	12	N.C.
	7	21	N.C.	21	N.C.
	8	22	N.C.	22	N.C.
	9	33	N.O.	31	N.C.
	19	34	N.O.	32	N.C.

Contact Action

Contact Open Contact Closed

Actuator withdrawal distance from full insertion

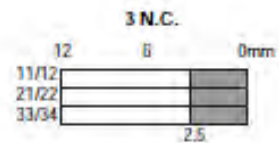
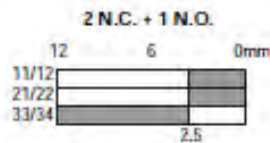

Application Details

4 possible actuator entry positions

